

[www.plasmacar.com](http://www.plasmacar.com)

**PlasmaCar**™

Pure Energy + Pure Fun

TURN THE STEERING  
WHEEL AND...

**AWAY YOU**

**GO!**



Choking and suffocation hazard  
Recommended age 3+



## How it works

The only power source the PlasmaCar requires is the seemingly limitless energy of a child. The PlasmaCar can reach an exhilarating 10 km/hour (6 mph).

**Note: The PlasmaCar is not recommended for use on wooden floors. The wheels may damage some floors.**

1. Place the PlasmaCar on a smooth, flat surface.
2. Sit with the feet on the footrests, lean slightly forward, and grip the steering wheel.
3. To propel the car forward, turn the steering wheel back and forth continuously. To go in reverse, rotate the steering wheel 180 degrees.
4. To bring the PlasmaCar to a stop, stop turning the wheel, wait for the car to slow, and put your feet on the ground.

**WARNING!**  
**Adult Assembly Required**

# Safety Guidelines



The PlasmaCar meets or exceeds all International safety standards including EN71, ASTM F963-07 and US CPSIA

## Follow these safety guidelines:

- When unpacking the PlasmaCar, properly dispose of all plastic wrappings.
- Adult supervision is strongly recommended at all times.
- Never use the PlasmaCar near steps, swimming pools, or vehicle traffic.
- Never use the PlasmaCar on a hill, steep slope, or over rough or uneven surfaces.
- To prevent falls, the child should sit leaning slightly forward.
- The maximum load should not exceed 55 kg (120 lbs) on uneven surfaces, or 100 kg (220 lbs) on smooth surfaces.



Choking and suffocation hazard.  
Recommended age 3+

# Assembly

## Included:

1. Body
2. Steering wheel assembly
3. Front wheel assembly with foam sheath
- 4a. Right rear wheel (packed in a blue bag)
- 4b. Left rear wheel
5. Steering wheel cap
6. Hex key

**Tools Required:** Rubber mallet, screwdriver or 17mm socket wrench

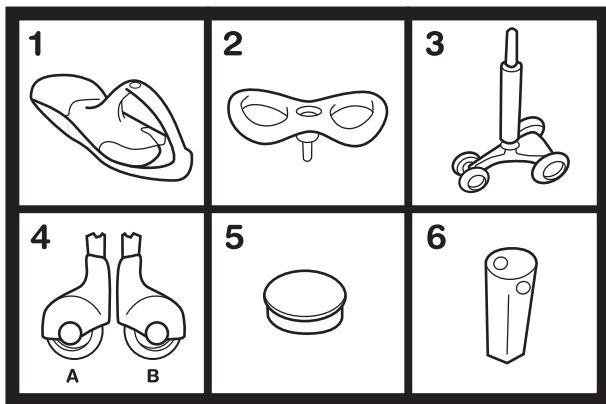

1

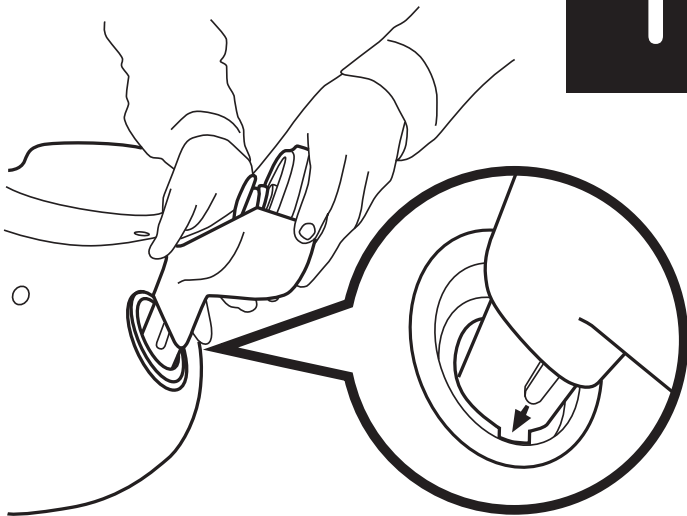

---

Fit the notch on each rear wheel housing into the body. Push the wheels in at a 45 degree angle. When installed correctly, the rear wheels flare out from the body.

**Warning: The rear wheel housing cannot be removed once locked into place.**

# 2

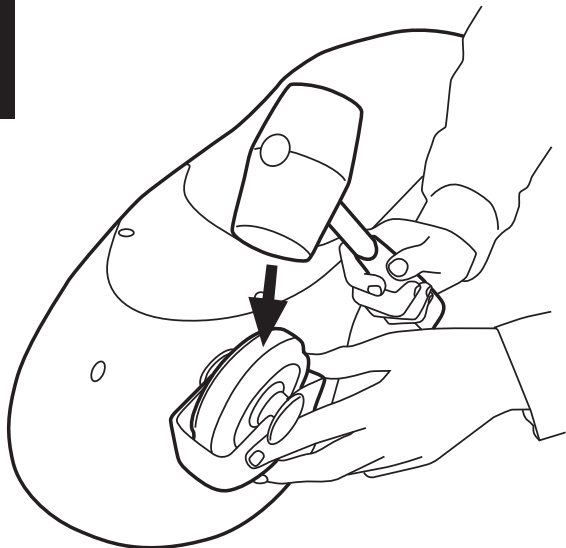

---

**Strike the rear wheels with a rubber mallet to secure them in place.**

***Note: To use a steel hammer, place a small block of wood on the area to be struck.***

3

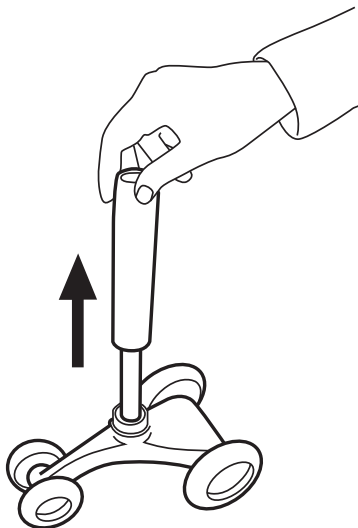

---

**Remove the foam sheath from the front wheel assembly.**

4

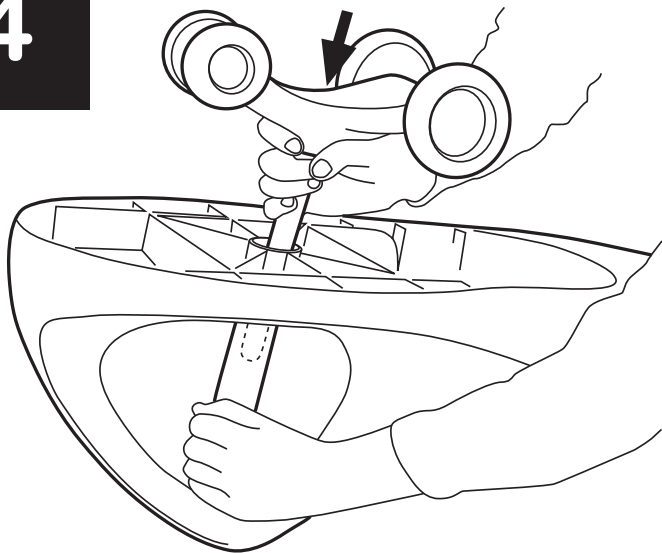

**Guide the front wheel shaft through the body, into the foam sheath, and through the hole at the top of the body.**

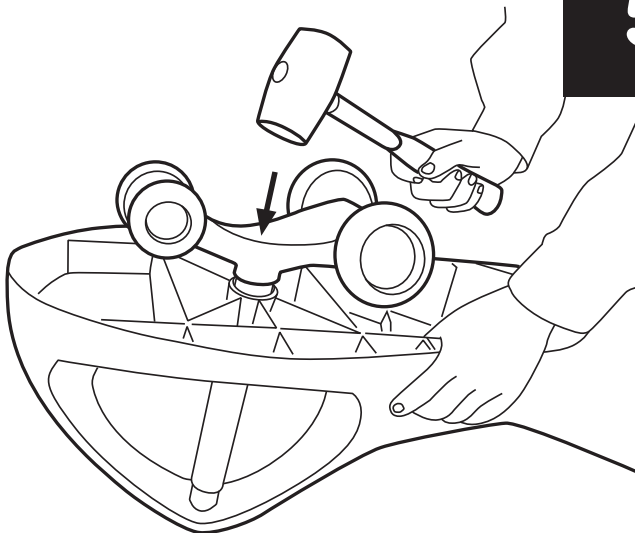

**Strike the base of the front wheel assembly with a rubber mallet. The metal bearing should be seated securely in the body.**

# 6

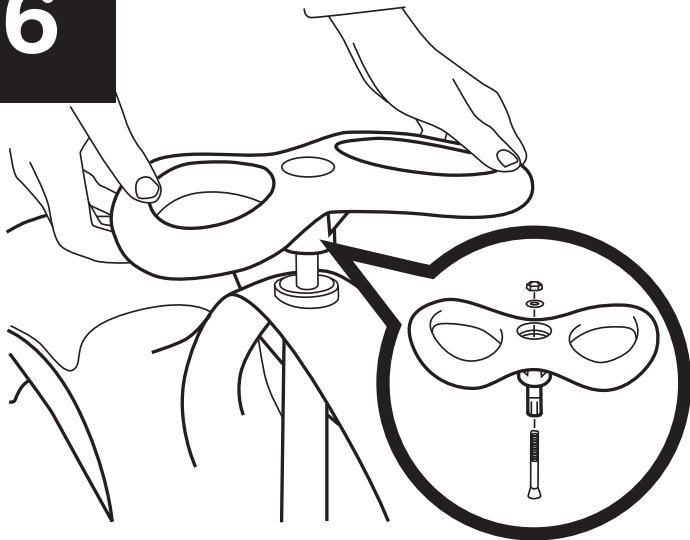

**Fit the steering wheel into the top of the front wheel assembly.**

***Note: Ensure that the bolt is attached to the steering wheel as shown.***

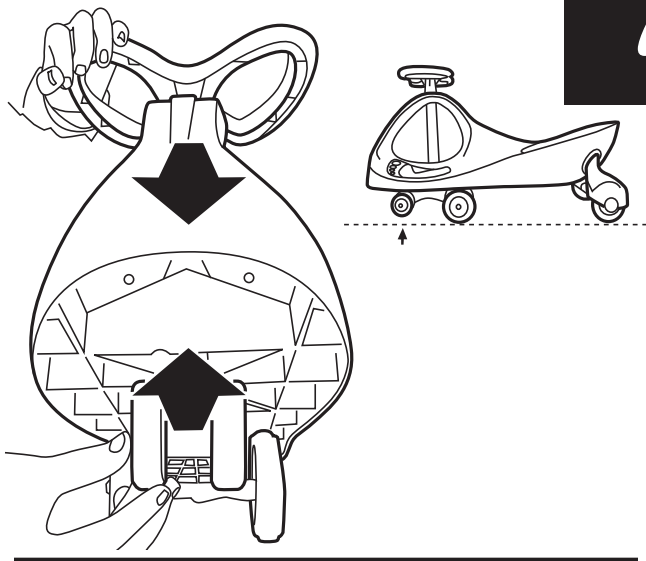

**Align the steering wheel with the smaller front wheels, so that the wide end of the steering wheel faces forward.**

***Note: When the front wheels are assembled and resting on a flat surface, the smaller front wheels do not contact the ground.***

# 8

# IMPORTANT!

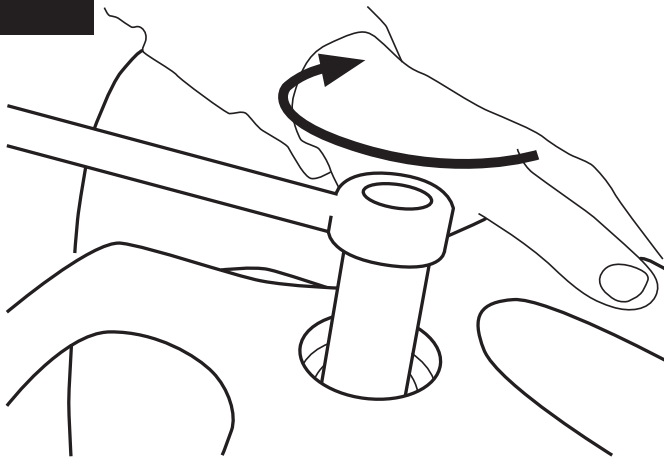

---

**This step is critical to the performance of your PlasmaCar.**

Use a 17mm socket wrench to tighten the nut in the steering column **AS TIGHT AS YOU POSSIBLE**. Fit the wrench onto the nut and turn until very tight.

Alternately, use the enclosed hex key and a screw driver to tighten the nut **AS TIGHT AS POSSIBLE**.

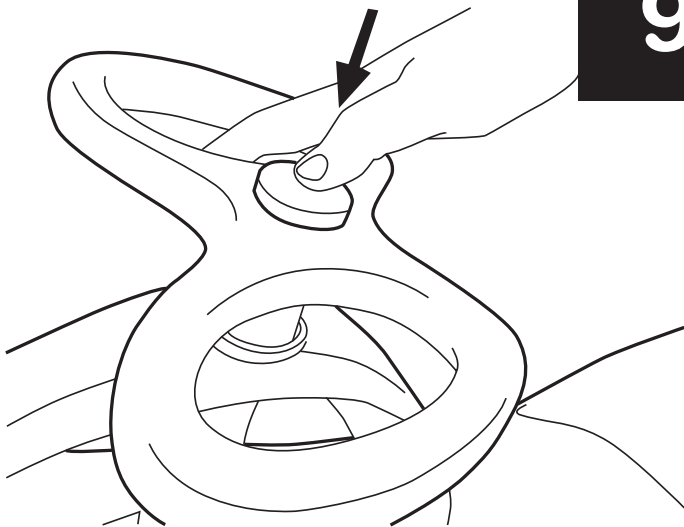

---

**Push the cap into the steering wheel.**

# Troubleshooting

The rear wheels may detach from their housing if the PlasmaCar is subjected to overloading or impact. Fit the wheel into its housing so that the flat sides of the white clips contact the wheel housing. Snap the wheel back into place.

If the steering wheel becomes loose or fails to propel the PlasmaCar, the steering wheel nut may not have been tightened enough during assembly. Remove the cap from the steering wheel with a slot screwdriver and loosen the nut with the hex key. Repeat steps 7 and 8, securing the nut as tightly as possible.



## RECOGNIZED BY

- 2009: National Parenting Center, Seal of Approval  
2008: iParenting Media Toy Award in the Toy Category  
2008: Fat Brain Toy Award in the Active Play Category  
2007: TD Monthly, Top Toy Award  
2006: TIA (Toy Industry Association),  
Toy of the Year Nomination in the following  
two categories: Outdoor Toy of the Year &  
Specialty Toy of the Year  
2006: Learning Express Stores,  
Most Innovative New Product  
2006: Oppenheim Toy Portfolio, Platinum Award  
2005: Oppenheim Toy Portfolio, Gold Seal Award  
2005: Creative Child, Seal of Excellence  
2003: NETS (Neighbourhood Toys Stores of Canada),  
Gold Star Toy Award  
2003: Today's Parent, Top Toy List (Wow! Status)  
2001: Gold Medal, International Patent Fair, Hong Kong

**NO BATTERIES,  
GEARS  
OR PEDALS**

**SLEEK,  
INNOVATIVE  
DESIGN**

**GREAT EXERCISE  
INDOORS OR  
OUTDOORS**



[www.plasmacar.com](http://www.plasmacar.com)

